

This document is the property of Nian-Yeong Corporation and is delivered on the express condition that it is not to be disclosed, reproduced or used, in whole or in part, for manufacture or sale by anyone other than Nian-Yeong Corporation without its prior consent, and that no right is granted to disclose or to use any information in this document.

CUSTOMER DRAWING

| REV. | DESCRIPTION | APPROVED BY | DATE | ECN NO. |
|------|-------------|-------------|-----------|---------|
| A | RELEASE | LED | 03/01/25* | |
| B | | | | |
| C | | | | |

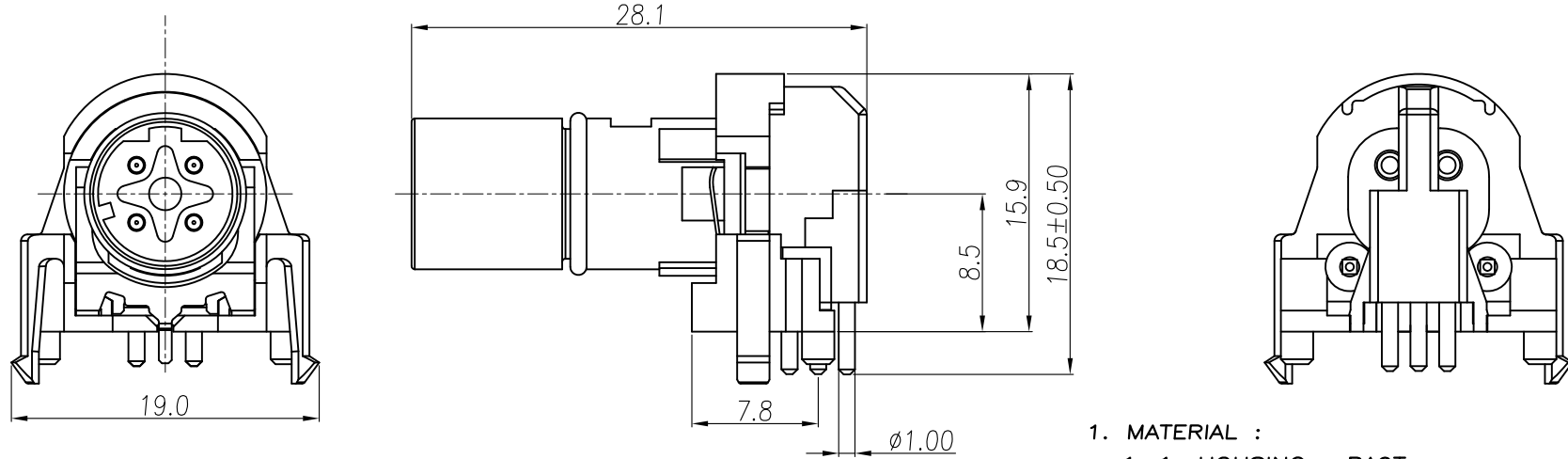

TABLE A

| | |
|----------------|----------------|
| | |
| WP-04M2-280-11 | WP-05M2-239-11 |

1. MATERIAL :

- 1-1. HOUSING : PA9T
- 1-2. CONTACT : BRASS
- 1-3. O-RING : VITON
- 1-4. BACK HOUSING : PA9T
- 1-5. DOWN HOUSING : PA9T
- 1-6. GROUND : PHOSPHOR BRONZE

2. FINISH :

- 2-1. CONTACT : GOLD FLASH PLATED.
- 2-2. GROUND : NICKEL PLATED.

3. ELECTRICAL SPECIFICATION :

- 3-1. Rated current : 4A
- 3-2. Rated Voltage : 4PIN 250V ;5PIN 60V
- 3-3. Water proof : IP67 (in mated condition)

4. Environmental :

- 4-1. Operation Temperature : -25°C~85°C

| | | | | | | | | | | | | | |
|-------|---------|-------|---------|-------|-----|---|--|--|----------|-----------------------------------|---------|---------|---------|
| DRAWN | LED | APP'D | Ku Chou | UNIT | mm | TOLERANCE | | | TITLE | WP M12 D-CODING (M) Two-piece 90度 | | | SHEET |
| CHK'D | Ku Chou | | | SCALE | 1:1 | .x ±0.20 .xx ±0.10 .xxx ±0.05 .xxxx ±0.03 ANGULAR ±1° | | | PART NO. | SEE TABLE A | DWG NO. | QC11229 | |
| | | | | | | | | | 年永實業有限公司 | | | | VERSION |
| | | | | | | | | | | | | | A |

This document is the property of Nian-Yeong Corporation and is delivered on the express condition that it is not to be disclosed, reproduced or used, in whole or in part, for manufacture or sale by anyone other than Nian-Yeong Corporation without its prior consent, and that no right is granted to disclose or to use any information in this document.

CUSTOMER DRAWING

| REV. | DESCRIPTION | APPROVED BY | DATE | ECN NO. |
|------|-------------|-------------|-----------|---------|
| A | RELEASE | LED | 03/01/25* | |
| B | | | | |
| C | | | | |

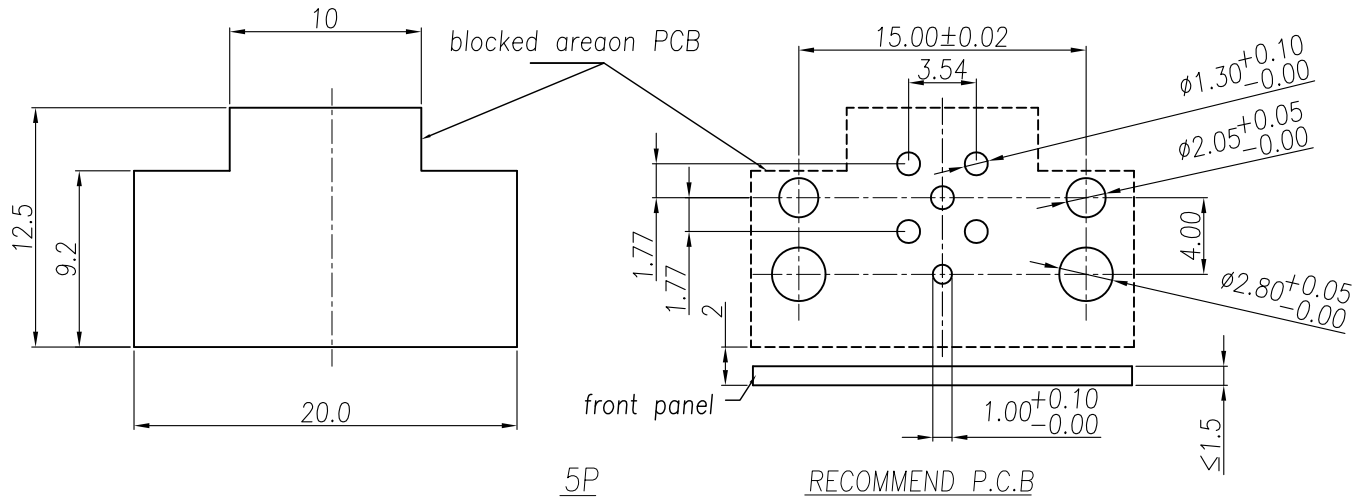
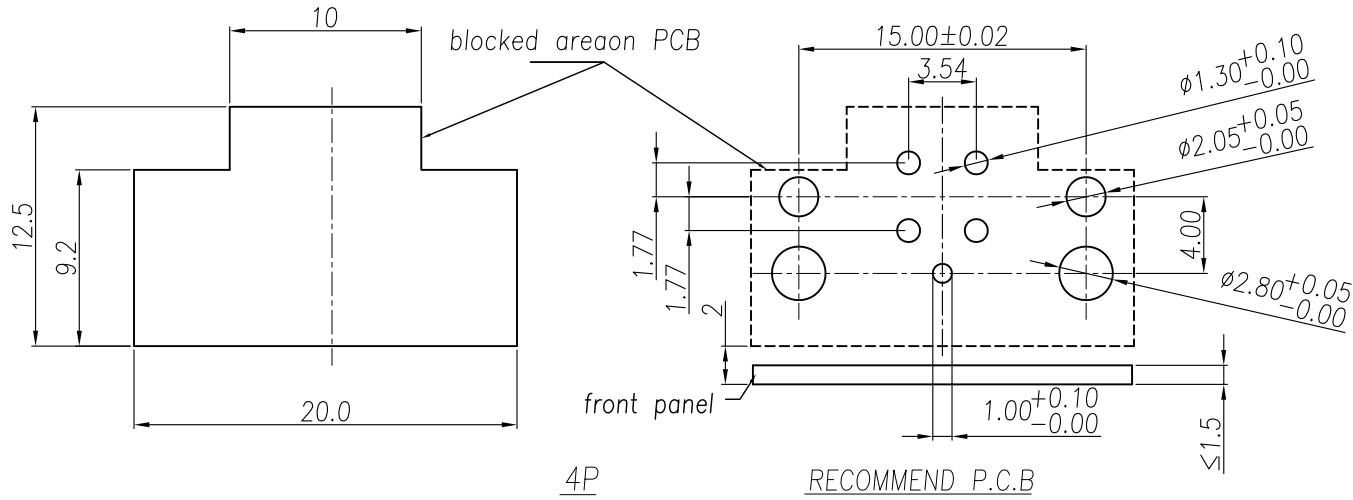

| | | | | | | | | | | | | | |
|-------|---------|-------|---------|-------|-----|---|--|--|----------|-----------------------------------|---------|---------|---------|
| DRAWN | LED | APP'D | Ku Chou | UNIT | mm | TOLERANCE | | NIAN YEONG ENTERPRISE 年永實業有限公司 | TITLE | WP M12 D-CODING (M) Two-piece 90度 | | | SHEET |
| CHK'D | Ku Chou | | | SCALE | 1:1 | .x ±0.10 .xx ±0.05 .xxx ±0.03 .xxxx ±0.01 ANGULAR ±1° | | | PART NO. | SEE TABLE A | DWG NO. | QC11229 | VERSION |