

This document is the property of Nian-Yeong Corporation and is delivered on the express condition that it is not to be disclosed, reproduced or used, in whole or in part, for manufacture or sale by anyone other than Nian-Yeong Corporation without its prior consent, and that no right is granted to disclose or to use any information in this document.

CUSTOMER DRAWING

REV.	DESCRIPTION	APPROVED BY	DATE	ECN NO.
A	PRELIMINARY RELEASE	Ku Chou	03/01/25'	
B				
C				

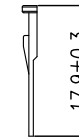
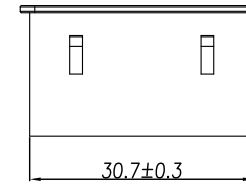
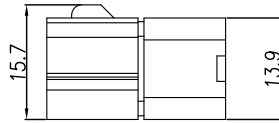
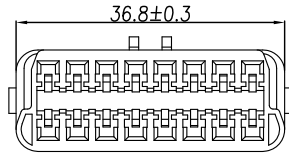
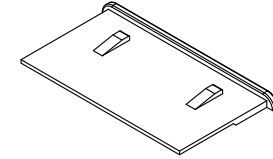
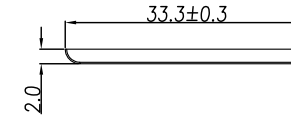
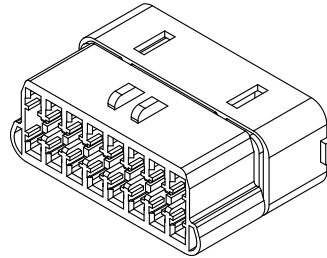
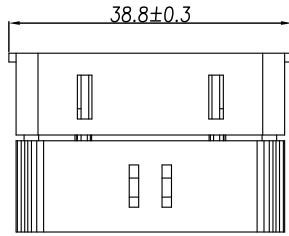

MAIN HOUSING

RETAINER

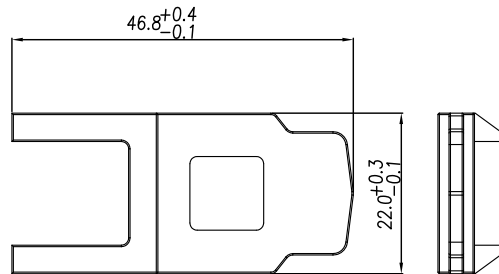
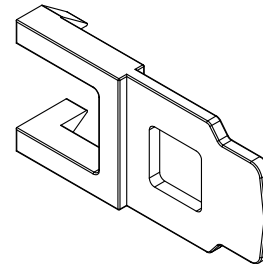
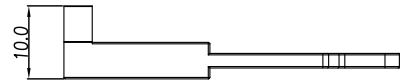
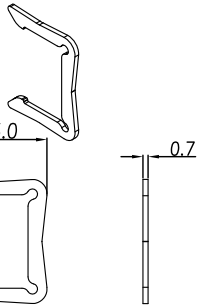

JAM MOUNT CLIP

REMOVAL TOOL

1. MATERIAL :
- 1-1. MAIN HOUSING : PA66 UL94V-0 ; COLOR : BLACK
  - 1-2. RETAINER : PA66 UL94V-0 ; COLOR : BLACK
  - 1-3. JAM MOUNT CLIP : STAINLESS STEEL 304
  - 1-4. REMOVAL TOOL : PA66 UL94V-0 ; COLOR : BLACK
  - 1-5. MOUNTING BRACKET 1 : PA66 UL94V-0 ; COLOR : BLACK
  - 1-6. MOUNTING BRACKET 2 : PA66 UL94V-0 ; COLOR : BLACK
  - 1-7. MOUNTING BRACKET 3 : PA66 UL94V-0 ; COLOR : BLACK
  - 1-8. MOUNTING BRACKET 4 : PA66 UL94V-0 ; COLOR : BLACK
  - 1-9. MOUNTING BRACKET 5 : PA66 UL94V-0 ; COLOR : BLACK
  - 1-10. MOUNTING BRACKET 5-2 : PA66 UL94V-0 ; COLOR : BLACK
  - 1-11. MOUNTING BRACKET 6 : PA66 UL94V-0 ; COLOR : BLACK
  - 1-12. MOUNTING BRACKET 7 : PA66 UL94V-0 ; COLOR : BLACK
  - 1-13. MOUNTING BRACKET 8 : PA66 UL94V-0 ; COLOR : BLACK
2. FINISH :
- 2-1. JAM MOUNT CLIP : PASSIVATION

DRAWN	Emily Suen	APP'D	Ku Chou	UNIT	mm	TOLERANCE			TITLE	UNIVERSAL CAR OBD2 CONNECTOR WITH MOUNTING BRACKET			SHEET
CHK'D	Ku Chou			SCALE	1:1	.x ±0.20 .xx ±0.10 .xxx ±0.05 .xxxx ±0.03 ANGULAR ±1°			PART NO.	OBD2-16F2-01-01	DWG NO.	QC11241	 VERSION A

**NIAN YEONG ENTERPRISE**  
年永實業有限公司

This document is the property of Nian-Yeong Corporation and is delivered on the express condition that it is not to be disclosed, reproduced or used, in whole or in part, for manufacture or sale by anyone other than Nian-Yeong Corporation without its prior consent, and that no right is granted to disclose or to use any information in this document.

CUSTOMER DRAWING

REV.	DESCRIPTION	APPROVED BY	DATE	ECN NO.
A	PRELIMINARY RELEASE	Ku Chou	03/01/25'	
B				
C				

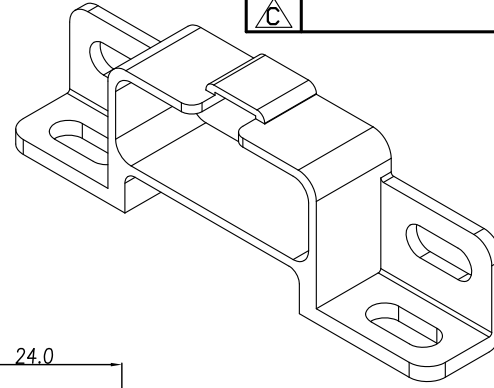
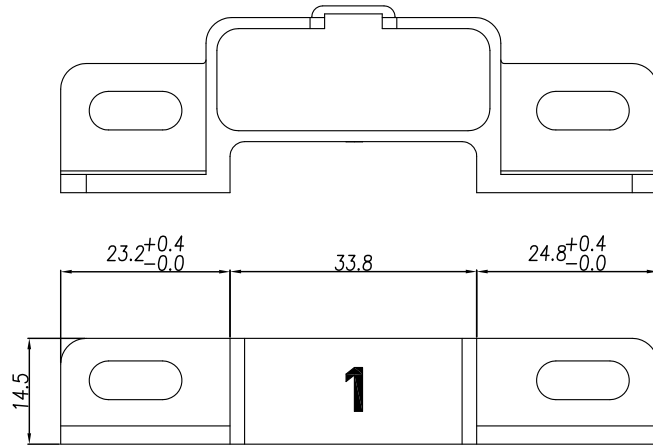

MOUNTING BRACKET 1

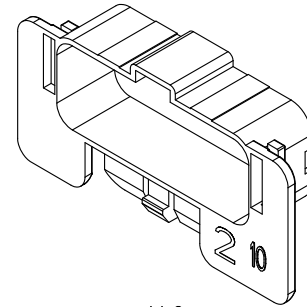
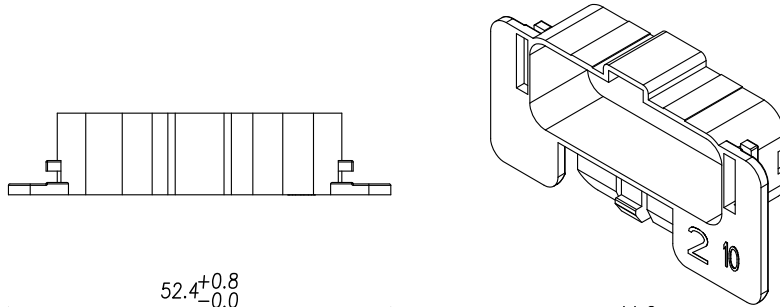

MOUNTING BRACKET 2

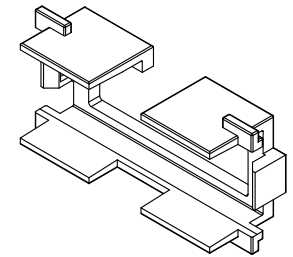
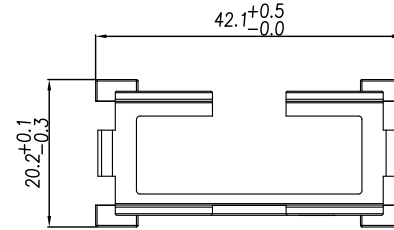

MOUNTING BRACKET 3

DRAWN	Emily Suen	APP'D	Ku Chou	UNIT	mm	TOLERANCE		<b>NIAN YEONG ENTERPRISE</b> 年永實業有限公司	TITLE	UNIVERSAL CAR OBD2 CONNECTOR WITH MOUNTING BRACKET			SHEET	2/4
CHK'D	Ku Chou			SCALE	1:1	.x ±0.20 .xx ±0.10 .xxx ±0.05 .xxxx ±0.03 ANGULAR ±1°			PART NO.	OBD2-16F2-01-01	DWG NO.	QC11241	VERSION	A

This document is the property of Nian-Yeong Corporation and is delivered on the express condition that it is not to be disclosed, reproduced or used, in whole or in part, for manufacture or sale by anyone other than Nian-Yeong Corporation without its prior consent, and that no right is granted to disclose or to use any information in this document.

# CUSTOMER DRAWING

REV.	DESCRIPTION	APPROVED BY	DATE	ECN NO.
A	PRELIMINARY RELEASE	Ku Chou	03/01/25'	
B				
C				

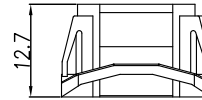
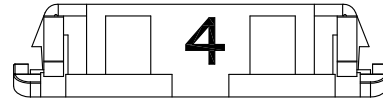
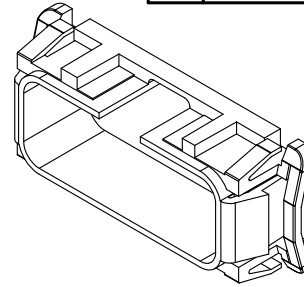
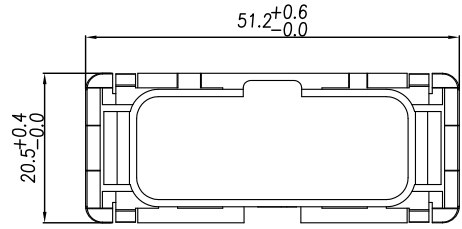

MOUNTING BRACKET 4

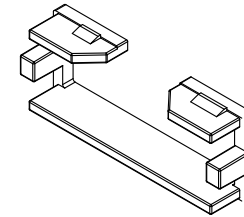
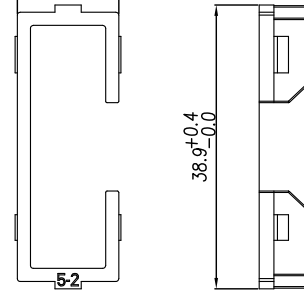
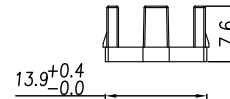
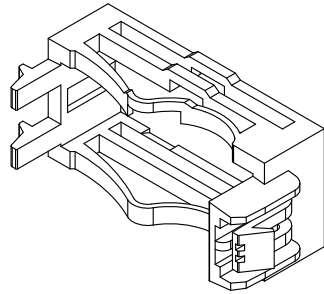
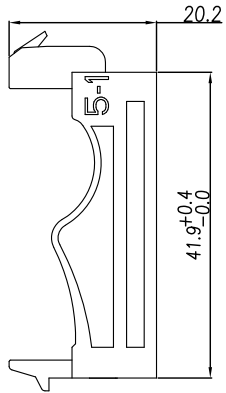

MOUNTING BRACKET 5

MOUNTING BRACKET 5-2

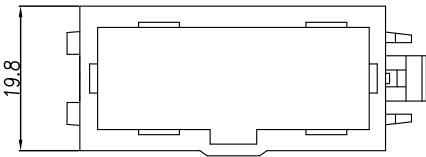
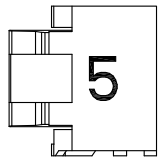

DRAWN	Emily Suen	APP'D	Ku Chou	UNIT	mm	TOLERANCE				TITLE	UNIVERSAL CAR OBD2 CONNECTOR WITH MOUNTING BRACKET			SHEET	3
CHK'D	Ku Chou			SCALE	1:1	.x ±0.20 .xx ±0.10 .xxx ±0.05 .xxxx ±0.03 ANGULAR ±1°				PART NO.	OBD2-16F2-01-01	DWG NO.	QC11241	VERSION	A

**NIAN YEONG ENTERPRISE**  
年永實業有限公司

This document is the property of Nian-Yeong Corporation and is delivered on the express condition that it is not to be disclosed, reproduced or used, in whole or in part, for manufacture or sale by anyone other than Nian-Yeong Corporation without its prior consent, and that no right is granted to disclose or to use any information in this document.

CUSTOMER DRAWING

REV.	DESCRIPTION	APPROVED BY	DATE	ECN NO.
A	PRELIMINARY RELEASE	Ku Chou	08/12/28*	
B				
C				

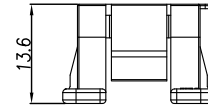
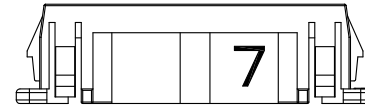
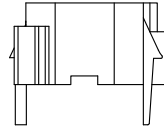
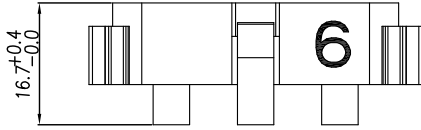
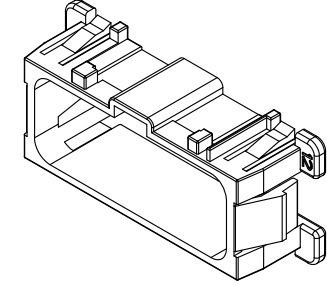
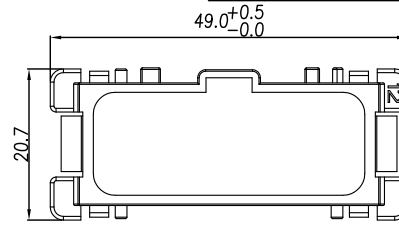
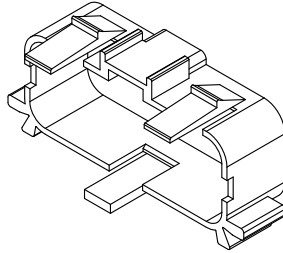
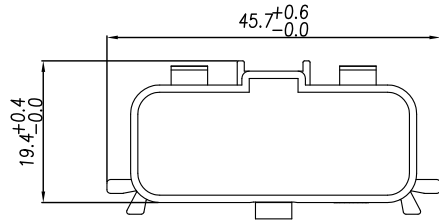

MOUNTING BRACKET 6

MOUNTING BRACKET 7

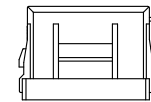
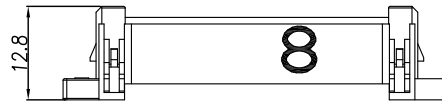
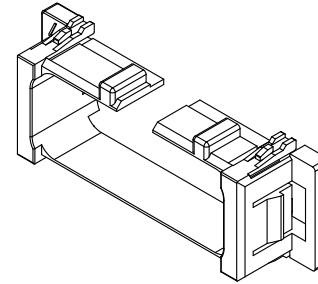
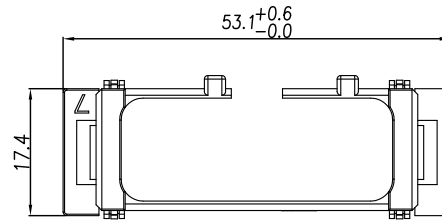

MOUNTING BRACKET 8

DRAWN	Emily Suen	APP'D	Ku Chou	UNIT	mm	TOLERANCE			TITLE	UNIVERSAL CAR OBD2 CONNECTOR WITH MOUNTING BRACKET			SHEET	
CHK'D	Ku Chou			SCALE	1:1	.x ±0.20 .xx ±0.10 .xxx ±0.05 .xxxx ±0.03 ANGULAR ±1°			PART NO.	OBD2-16F2-01-01	DWG NO.	QC11241	VERSION	

**NIAN YEONG ENTERPRISE**  
年永實業有限公司